

TOWN OF NEPEUSKUN SEC. 15

LOCATED IN THE NW 1/4 OF THE NW 1/4 OF  
SECTION 15, T17N, R14E, TOWN OF NEPEUSKUN,  
WINNEBAGO COUNTY, WISCONSIN.

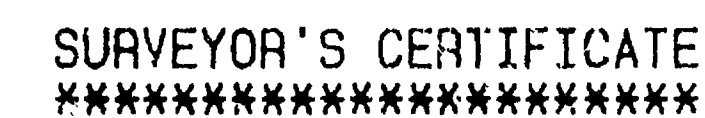

I, Sam T. Mullen, Registered Land Surveyor of the State of Wisconsin, hereby certify that I have at the order of Fred Boese, as owner thereof, surveyed lands located in part of the Northwest 1/4 of the Northwest 1/4 of Section 15, Town 17 North, Range 14 East, Town of Nepeuskun, Winnebago County, Wisconsin, being more particularly described as follows:

Beginning at the Northwest Corner of said Section 15; thence S 89°-40'-38" E along the north line of the Northwest 1/4 1029.71 ft.; thence S 00°-24'-02" W (this line being also along the west line of the "Town Dump") 885.68 ft. to the center of Tews Road; thence traversing along the centerline of Tews Road N 52°-28'-55" W 252.68 ft.; thence N 50°-49'-42" W 349.51 ft.; thence N 48°-49'-20" W 205.17 ft.; thence N 47°-28'-09" W 118.31 ft. to the end of the traverse along the centerline of Tews Road; thence N 89°-40'-38" W 311.46 ft. to the west line of the Northwest 1/4; thence N 00°-10'-46" E 300.00 ft. to the Point of Beginning, containing 12.069 acres and being subject to the road right-of-way that runs north-westerly along and thru the above described parcel; and being subject to all other easements and restrictions of record, if any.

I further certify that I have surveyed the property described hereon, and that the map, as shown hereon, is a true representation thereof and shows the size and location of all visible structures and dimensions of all principal buildings thereon, boundary fences, apparent easements, roadways and visible encroachments, if any, to the best of my knowledge and belief. This survey is made for the use of the present owners of the property, and for those who purchase, mortgage or guarantee the title thereto, as of the date hereon.

RIPON LAND SURVEYING  
Ripon, Wisconsin

Sam T. Mullen, R.L.S. 0981  
Dated this 16th day of December, 1991

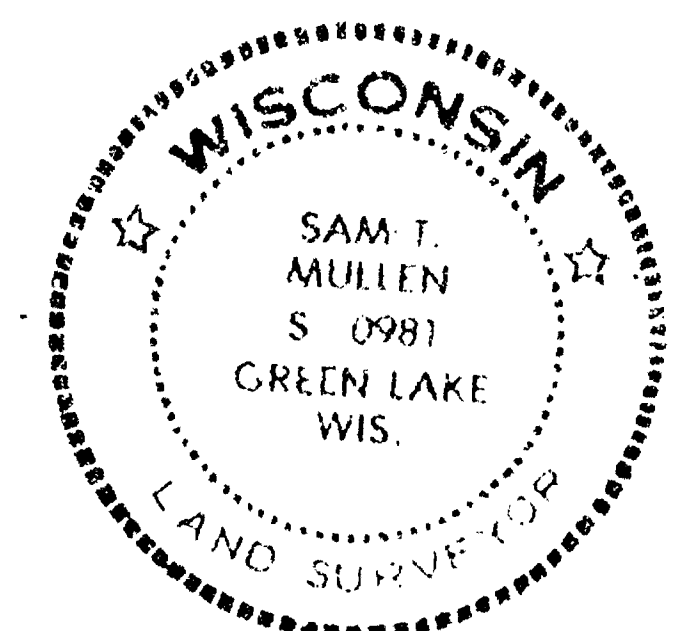

RIPON LAND SURVEYING

W764 BROOKLYN J ROAD  
AIPOL WISCONSIN 54971

FRED BOESE LANDS

FRED BOESE LANDS

DRAWN STW/JSM APPROVED BY STW	DATE 12/16/91 DATE 12/17/91	NW 1/4 NW 1/4, SECTION 15, T17N, R14E, TOWN OF NEPEUSKUN, WINNEBAGO COUNTY, WISCONSIN		
SCALE 1 INCH = 80 FEET		SHEET 1 OF 1	SHEET PROJECT NO. R9110-151714-33	

Sec 15 + 17 N R14 E



N.W. CORNER OF  
SECTION 15  
(BERNTSEN MONUMENT)

N. 1/4 CORNER OF  
SECTION 15  
(BERNTSEN MONUMENT)

S89°40'38"E

2651.03'

NORTH LINE OF THE N.W. 1/4  
OF SECTION 15

1029.71'  
(62 RODS OR 1023 FT.)

300.00'  
N00°10'50"E  
(N00°10'46"E)

WEST LINE OF THE  
N.W. 1/4 OF SECTION 15

(N89°40'38"W)  
N89°41'38"W (311.46)  
274.56'

WOOD AND WIRE  
FENCE

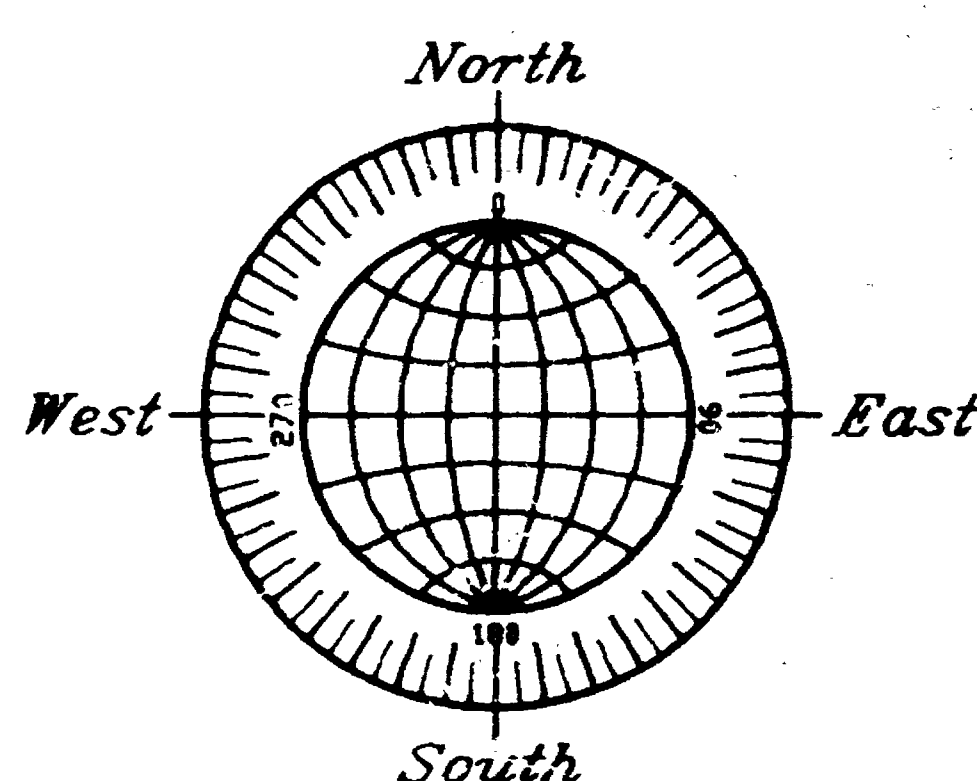

GRAPHIC SCALE



( IN FEET )  
1 inch = 100 ft.

- DENOTES MONUMENTATION FOUND AS DESCRIBED.
- DENOTES P.K. MASONRY NAIL FOUND (UNLESS OTHERWISE NOTED).
- DENOTES 3/4" DIAMETER IRON ROD, 24" LONG, SET.
- ( ) DENOTES RECORDED DIMENSION WHERE DIFFERENT FROM ACTUAL MEASUREMENT.

PARCEL AREAS:  
34.6534 ACRES TO  
CENTERLINE OF TEWS ROAD  
34.1307 ACRES TO  
SOUTH RIGHT OF WAY LINE  
OF TEWS ROAD

FENCING MAY EXIST  
ALONG PROPERTY LINE

2-STORY  
FRAME  
DWELLING  
#1633

ATTACHED  
GARAGE

302.9

261.0

## PLAT OF SURVEY

KNOWN AS 1633 TEWS ROAD. BEING THE WEST 62 RODS OF THE NORTH 120  
RODS OF THE N.W. 1/4 OF SECTION 15, T17N, R14E, IN THE TOWN OF  
NEPEUSKUN, WINNEBAGO COUNTY, WISCONSIN EXCEPT THE FOLLOWING  
DESCRIBED PARCEL:

BEGINNING AT THE N.W. CORNER OF SAID SECTION 15, THENCE SOUTH  
89°40'38" EAST ALONG THE NORTH LINE OF THE N.W. 1/4 OF SAID SECTION  
1029.71 FT., THENCE SOUTH 00°24'02" WEST (THIS LINE BEING ALSO  
ALONG THE WEST LINE OF THE "TOWN DUMP") 885.68 FT. TO THE CENTER  
OF TEWS ROAD, THENCE TRAVERSING ALONG THE CENTERLINE OF TEWS ROAD  
NORTH 52°28'55" WEST 252.68 FT., THENCE NORTH 50°49'42" WEST 349.51  
FT., THENCE NORTH 48°49'20" WEST 205.17 FT., THENCE NORTH 47°28'09"  
WEST 118.31 FT. TO THE END OF THE TRAVERSE ALONG THE CENTERLINE OF  
TEWS ROAD, THENCE NORTH 89°40'38" WEST 311.46 FT. TO THE WEST LINE  
OF THE N.W. 1/4 OF SAID SECTION, THENCE NORTH 00°10'46" EAST ALONG  
SAID LINE 300.00 FT. TO THE POINT OF BEGINNING. SAID PARCEL  
CONTAINS 34.6534 ACRES TO THE CENTERLINE OF TEWS ROAD (34.1307  
ACRES TO THE SOUTHERLY RIGHT OF WAY LINE OF TEWS ROAD) AND IS  
SUBJECT TO ALL EXISTING EASEMENTS AND RESTRICTIONS OF RECORD. THE  
NORTHEASTERLY 24.75 FT. OF SAID PARCEL IS RESERVED FOR PUBLIC RIGHT  
OF WAY.

DECEMBER 3, 1996 SURVEY FOR THE PREMIER GROUP NO. 3043

WOOD AND  
WIRE FENCE

(62 RODS OR 1023 FT.)  
1019.82'

S89°42'27"E

WIRE  
FENCE

N. 1/4 CORNER OF  
SECTION 15  
(BERNTSEN MONUMENT)

3/4" ROD  
0.8 NORTH  
AND 0.2 WEST  
OF TRUE  
CORNER

1.0

500.27' S87°28'02"W  
(500.27' S87°28'02"W)

P.K. NAIL 1.0 EAST  
OF TRUE CORNER

1" PIPE 3.5 EAST  
AND 13.6 SOUTH  
OF CORNER

1100.44'  
N00°27'58"E

1.3

WIRE  
FENCE

1" PIPE  
ON LINE

0.6

### SURVEYOR'S CERTIFICATE

I, Reinhard Roehlig, Wisconsin Registered Land Surveyor, certify  
that I have surveyed the above described property and that the  
above map is a correct representation thereof and shows the size  
and location of the property, its exterior boundaries, the  
locations and dimensions of all visible structures thereon,  
boundary fences, apparent easements and roadways and visible  
encroachments, if any.

This survey is made for the exclusive use of the present owners of  
the property and also those who purchase, mortgage or guarantee  
title thereto, within one (1) year from the date hereof.

12-4-96  
Date

Reinhard Roehlig, Registered  
Wisconsin Land Surveyor 8-1308



DECEMBER 4, 1996

ROEHLIG

LAND SURVEYING  
&  
CONSULTING LTD.

417 North Sawyer Street • Oshkosh WI • 54901  
(414) 233-2884

NO. 3043

SEC 15 TOWN 17 RANGE 14