

That part of the South 1/2 of the NORTH WEST 1/4 of Section Thirty-one (31) Township Twenty (20) North, of Range Seventeen (17) East, in the Town of Neenah, Winnebago County, Wisconsin, described as follows, viz:-

Commencing at a point that is 893.5 feet north and 1401.5 feet east of the Southwest corner of said North West 1/4; thence west, 217.8 feet; thence south, 100 feet; thence east, 217.8 feet; thence north 100 feet, to the place of beginning.

1 STORY HOUSE WITH ATTACHED GARAGE

NO BUILDING ENCROACHMENTS PRESENT

DEPPE: 115 DELL CT.  
NEENAH, WISCONSIN.

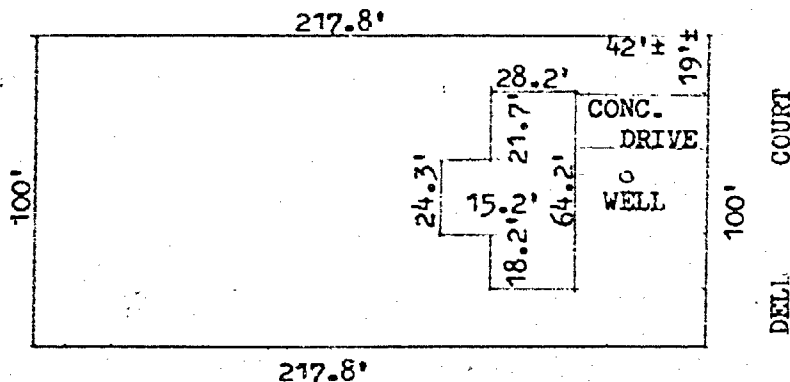
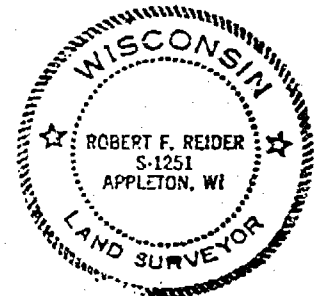

I, ROBERT F. REIDER  
certify that this mortgage inspection was made by me or under my direction and control of the described property on, MARCH 22, 1984, according to the official records and that this drawing is a true representation of the principal building lines thereon and is accurate to the best of my knowledge and belief. Fleet Mortgage Corp., in agreement with Carow Land Surveying Co., Inc. has waived parts of Administrative Code A-E 5.01 (3 through 7). THIS IS NOT A BOUNDARY SURVEY NOR INTENDED TO BE. THIS MORTGAGE INSPECTION IS MADE FOR THE EXCLUSIVE USE OF: Fleet Mortgage Corp.

*Robert F. Reider 3-22-84*  
LSC

NOTE:

RE: EASEMENTS RECORDED IN VOL. 623 PAGE 625,  
VOL 813 PAGE 503.

There are no visible easements located on, over or across subject property. However said easement cannot be specifically located.

REVISIONS	Fleet Mortgage Corp.		
	3127 W. Spencer St., Appleton, Wis. 54911		
	CAROW LAND SURVEYING CO., INC., P.O. BOX 1297		
	1837 W. WISCONSIN AVE. • APPLETON, WI 54912		
DRAWN BY	MV-ec	SCALE	1"=60'
DATE	3-22-84	DRAWING NO.	843-188
APPROD	<i>[Signature]</i>		