

Plat of Survey

Lot 13 in Block One, of Homestead Acres, located in the Southwest 1/4 of the Southeast 1/4 of Section 12, Township 20 North, Range 17 East, Village of Fox Crossing, Winnebago County, Wisconsin



Bearings are referenced to the West line of the Southeast 1/4 of Section 12, T20N, R17E, assumed to bear N00°22'11"E, base on the Winnebago County Coordinate System.

Survey for:
Ethan Mason
1038 Home Ave.
Menasha, WI 54952

Lot 117
Meadowview Acres

Lot 118
Meadowview Acres

Lot 119
Meadowview Acres

LEGEND

- 3/4" x 18" Steel Rebar @ 1.50lbs/LF SET
- 1" Iron Pipe Found
- 2" Iron Pipe Found
- 3/4" Rebar Found
- ⊙ Government Corner
- () Recorded As
- Ⓜ Well

Lot 14
Block One
Homestead Acres

(S 89°26' E) (150')
S 89°02'17" E 149.89'

Existing Garage

Existing Access

Existing Dwelling

Lot 13

13,481 Sq. Feet
0.3095 Acres

#1038

N 89°02'17" W 149.89'
(S 89°26' E) (150')

Lot 12
Block One
Homestead Acres

R/W Corner (PC)
Lot 9 Block One

Surveyor's Certificate

I, Scott R. Andersen, Professional land surveyor, hereby certify that in full compliance with the provisions of Chapter A-E 7 of the Wisconsin Administrative Code, and under the direction and control of Ethan Mason, the property owners, that this survey is correct to the best of my knowledge and belief, and that this land is All of Lot 13 in Block One, of Homestead Acres, located in the Southwest 1/4 of the Southeast 1/4 of Section 12, Township 20 North, Range 17 East, Village of Fox Crossing, Winnebago County, Wisconsin and subject to all easements and restrictions of record.

Field work was completed on 2022.04.19

South 1/4 Corner
Section 12, T20N, R17E
Fnd Alum. Mon. Tipped,
Location per found Ties



**DAVEL ENGINEERING &
ENVIRONMENTAL, INC.**
Civil Engineers and Land Surveyors

1164 Province Terrace, Menasha, WI 54952
Ph: 920-991-1866 Fax: 920-441-0804
www.davel.pro

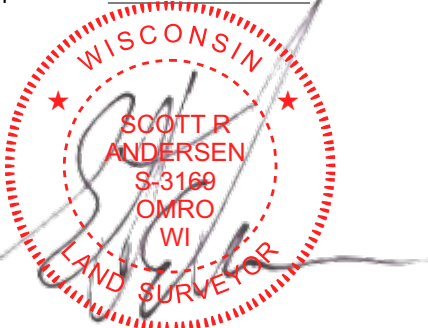

Drafted by: scott
04/22/2022
Sheet : 1 of 1