

THE LOCATION OF THIS SECTION CORNER HAS BEEN RELOCATED BY ANOTHER SURVEY AND ACCEPTED BY WINNEBAGO COUNTY AS THE PROPER LOCATION SINCE C.S.M. NO. 2710 WAS RECORDED

SOUTHWEST CORNER SEC. 1-20-17 CUT "X" FOUND

SECTION LINE PER C.S.M. NO. 2710

SOUTH 1/4 CORNER SEC. 1-20-17 COUNTY MON. FND

**PROPERTY DESCRIPTION:**  
Lot Two 2, of Certified Survey Map No. 2710, filed in the office of the Register of Deeds for Winnebago County, Wisconsin in Volume 1 of Certified Survey Maps on Page 2710 as Document No. 832606, being part of the SW 1/4 and SE 1/4 of the SW 1/4 Section 1, Township 20 North, Range 17 East, Town of Menasha, Winnebago County, Wisconsin.

also, All that land lying South of and adjacent to the above described Lot 2 and the Southerly extension of the East and West line of said Lot 2 to the South line of the Southwest 1/4 of said Section 1 as currently located.

**LEGEND**

- - 3/4" x 24" ROUND IRON BAR WEIGHING 1.5 lbs./lined ft. SET
- ✕ - 1 1/4" ROUND STEEL BAR FOUND
- ✕ - 3/4" ROUND STEEL BAR FOUND
- - 1" PIPE FOUND
- ⊙ - CERTIFIED LAND CORNER WINNEBAGO COUNTY
- ( ) - RECORDED BEARING AND/OR DISTANCE
- S.F. - SQUARE FEET

BEARINGS ARE REFERENCED TO THE SOUTH LINE OF THE SW 1/4 OF SECTION 1, T20N, R17E, TOWN OF MENASHA, WINNEBAGO COUNTY, WHICH IS ASSUMED TO BEAR S89°32'57"W

SURVEY FOR:  
BLX CAPITAL, LLC  
ATTN: ERIN BILKO  
1671 JEFFERSON DAVIS HIGHWAY, SUITE 104  
FREDERICKSBURG, VA 22401

THIS SURVEY WAS PREPARED WITH THE USE OF A TITLE POLICY BY EVANS TITLE AS COMMITMENT NO. 1008480.

**SURVEYOR'S ALTA CERTIFICATE**

I hereby certify to:

That I have surveyed the above described property and that the above map is a true representation thereof and shows the size and location of the property, its exterior boundaries, the location of all structures, boundary fences, apparent easements, roadways and visible encroachments, if any. This survey is made for the use of the present owners of the property, and also those who purchase, mortgage, or guarantee the title thereto for any portion thereof within one (1) year from date hereof. Complying with Chapter A-E7 Wisconsin "Minimum Standards for Property Surveys".

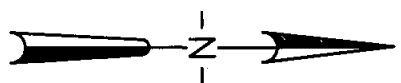
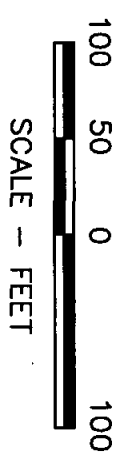
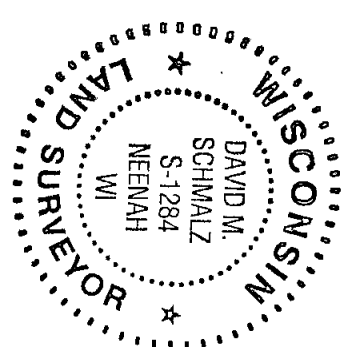

**SHORT FORM ALTA SURVEY**  
**1330 MIDWAY ROAD**  
**MENASHA, WI 54952**

SURVEYED
DRAWN MJA
CHECKED DEW

McMahon Associates, Inc. provides this drawing and data, regardless of form, as instruments of service. All rights including copyrights are retained by McMahon Associates, Inc. The client and/or recipient agrees to the fullest extent permitted by law to indemnify and hold McMahon Associates, Inc. harmless for any reuse of or changes made to the original drawing or data without prior written consent by McMahon Associates, Inc.

**McMAHON ASSOCIATES, INC.**  
1445 McMahon Drive Neenah, WI 54956  
Mailing Address:  
P.O. Box 1025 Neenah, WI 54957-1025  
TEL: 920-751-4200 FAX: 920-751-4284

- ENGINEERS
- ARCHITECTS
- PROJ. MGRS.
- SURVEYORS

SCALE 1" = 100'
DATE DEC., 2004
PROJECT NO. B0984 940889
SHEET NO. 1
FILE NO.