

Part of the Southeast 1/4 of the Southeast 1/4 of Section 36,
Township 20 North, Range 16 East, Town of Clayton, Winnebago County, Wisconsin

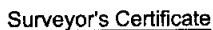

I, James R. Sehloff, registered land surveyor, hereby certify that in full compliance with the provisions of Chapter A-E 7 of the Wisconsin Administrative Code, and under the direction and control of Kathryn Fenton, the property owner, that this survey is correct to the best of my knowledge and belief, and that this land is located in part of the Southeast 1/4 of the Southeast 1/4 of Section 36, Township 20 North, Range 16 East, Town of Clayton, Winnebago County, Wisconsin, containing 13,518 Square Feet (0.3103 Acres) of land described as follows:

Commencing at the South 1/4 Corner of said Section 36; thence along the South line of the Southeast 1/4 of said Section, N89°21'14"E, 1708.18 feet; thence N00°09'34"W, 848.83 feet to the centerline of C.T.H. "JJ"; thence along said centerline, N51°04'16"E, 571.63 feet to the point of beginning; thence continuing along said centerline, N51°04'16"E, 75.10 feet; thence S38°40'18"E, 180.00 feet; thence S51°04'16"W, 75.10 feet; thence N38°40'18"W, 180.00 feet to the point of beginning, subject to all easements and restrictions of record.

Given under my hand this 22 day of MAY, 20 09

James R. Sebloff, Wisconsin Registered Land Surveyor No. S-2692

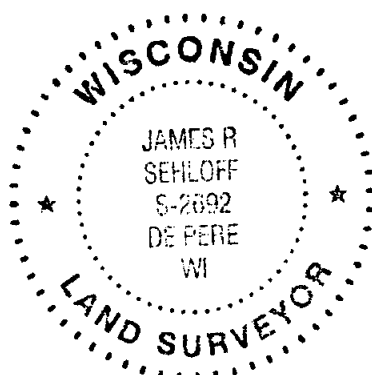
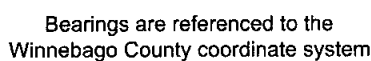

- ¾" x 18" Steel Rebar @ 1.50lbs/LF SET
- Masonry (PK) Nail SET
- Railroad Spike SET
- 1" Iron Pipe Found
- ¾" Rebar Found
- ⊗ Government Corner
- () Recorded As

Survey for:
Kathryn Fenton
2545 CTH JJ
Neenah, WI 54956

File: 3433pos.dwg
Date: 05/22/2009
Drafted By: eric
Sheet: POS



Davel Engineering, Inc.
Civil Engineers and
Land Surveyors
1811 Racine Street
Menasha, Wisconsin
Ph. 920-991-1866, Fax 920-830-9595