

SURVEY FOR
DAVID WEYLAND
8653 CENTER RD.
NEENAH, WI 54956

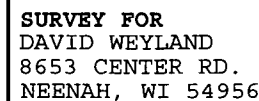

1" = 200'

0 200 400

SCALE IN FEET

PART OF THE SOUTHWEST 1/4 OF THE NORTHWEST 1/4, SECTION 20, TOWNSHIP 20 NORTH, RANGE 16 EAST, TOWN OF CLAYTON, WINNEBAGO COUNTY, WISCONSIN, MORE FULLY DESCRIBED AS FOLLOWS:

COMMENCING AT THE NORTHWEST CORNER OF SECTION 20; THENCE SOUTH 00 DEGREES 21 MINUTES 03 SECONDS EAST, ALONG THE WEST LINE OF THE NORTHWEST 1/4 OF SAID SECTION, A DISTANCE OF 1327.27 FEET; THENCE NORTH 88 DEGREES 47 MINUTES 51 SECONDS EAST, ALONG THE NORTH LINE OF THE SOUTHWEST 1/4 OF THE NORTHWEST 1/4 OF SAID SECTION, A DISTANCE OF 835.85 FEET TO THE POINT OF BEGINNING; THENCE NORTH 88 DEGREES 47 MINUTES 34 SECONDS EAST, CONTINUING ALONG THE NORTH LINE OF THE SOUTHWEST 1/4 OF THE NORTHWEST 1/4 OF SAID SECTION, A DISTANCE OF 452.91 FEET; THENCE SOUTH 00 DEGREES 20 MINUTES 41 SECONDS EAST, ALONG THE EAST LINE OF SAID SOUTHWEST 1/4 OF THE NORTHWEST 1/4, A DISTANCE OF 1046.94 FEET; THENCE NORTH 89 DEGREES 28 MINUTES 21 SECONDS WEST, A DISTANCE OF 701.30 FEET; THENCE NORTH 13 DEGREES 13 MINUTES 08 SECONDS EAST, ALONG THE EAST LINE OF LOT 1 OF CERTIFIED SURVEY MAP NO. 6840, A DISTANCE OF 1059.02 FEET; TO THE POINT OF BEGINNING. CONTAINING 599,318 SQ.FT. [13.758 ACRES].

I, MICHAEL L. ROUBAL, HEREBY CERTIFY THAT I HAVE SURVEYED THIS PROPERTY AND THIS MAP IS A TRUE REPRESENTATION THEREOF AND IS, TO THE BEST OF MY KNOWLEDGE AND BELIEF, A TRUE AND ACCURATE REPRESENTATION THEREOF.

DATED THIS 5TH DAY OF APRIL, 2017.

MICHAEL L. ROUBAL, PROFESSIONAL LAND SURVEYOR S-2442

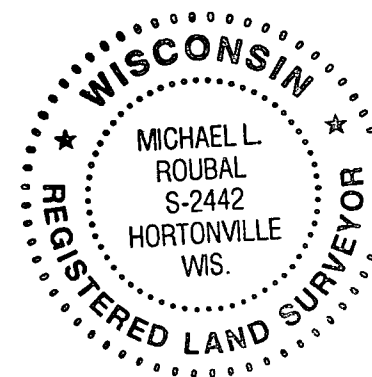
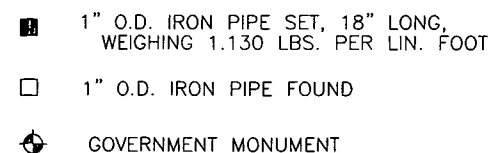

PLAT OF SURVEY

PART OF THE SOUTHWEST 1/4 OF THE NORTHWEST 1/4,
SECTION 20, TOWNSHIP 20 NORTH, RANGE 16 EAST,
TOWN OF CLAYTON, WINNEBAGO COUNTY, WISCONSIN.

[illegible]

| | |
|--------------------------------|------------------|
| SCALE 1"=200' | DATE APR 2017 |
| COMPUTER FILE 1-0932-001pos | |
| DRAWING NO. 1-0932-001 | |

Martenson & Eisele, Inc.

 1377 Midway Road
 Menasha, WI 54952
www.martenson-eisele.com
info@martenson-eisele.com
 920.731.0381 / 1.800.238.0381
 Planning
 Environmental
 Surveying
 Engineering
 Architecture