

CLIENT:  
TOM & MARGARET KRIEFALL  
7849 BOOM BAY HEIGHTS RD.  
LARSON, WI 54947

PIN:  
032056608

## LEGEND

- = 1 1/4" X 18" O.D. IRON PIPE SET,  
WEIGHING 1.68 LBS PER LIN. FT.  
WITH CAROW LAND SURVEYING CAP
- = EXISTING 1 1/4" O.D. IRON PIPE
- = EXISTING 3/4" IRON REBAR
- ⊙ = EXISTING BERNTSEN MONUMENT
- ▲ = WOOD LATH SET ON LINE
- ( ) = RECORDED AS BEARING/DIMENSION
- [ ] = PREVIOUSLY SURVEYED BEARING/DIMENSION  
PER SURVEY (X)

NOTES:  
- NOT ALL IMPROVEMENTS SHOWN PER CLIENT'S INSTRUCTIONS  
- PRIOR TO ANY CONSTRUCTION OR OTHER LAND USE ACTIVITY,  
ALL BUILDING SETBACKS AND OTHER LAND USE REQUIREMENTS  
SHOULD BE VERIFIED WITH THE TOWN OF WOLF RIVER AND  
WINNEBAGO COUNTY  
- FIELD WORK COMPLETED: 8/27/2025

# PLAT OF SURVEY

N/L OF THE NE 1/4 OF SECTION 26-20-14

NORTHEAST  
CORNER OF  
SECTION  
26-20-14

2659.08'

## LEGAL DESCRIPTION OF PARCEL "A":

PART OF A VACATED PUBLIC ROAD IN BOOM BAY HEIGHTS, LOCATED  
IN GOVERNMENT LOT 2 OF SECTION 26, TOWNSHIP 20 NORTH, RANGE  
14 EAST, TOWN OF WOLF RIVER, WINNEBAGO COUNTY, WISCONSIN,  
BOUNDED AND DESCRIBED AS FOLLOWS: COMMENCING AT THE  
NORTHEAST CORNER OF SAID SECTION 26; THENCE N89°21'58"W,  
1541.61 FEET ALONG THE NORTH LINE OF THE NORTHEAST 1/4 OF  
SECTION 26 TO THE NORTHWESTERLY EXTENSION OF THE SOUTHWEST  
LINE OF BOOM BAY HEIGHTS ROAD; THENCE S37°20'04"E, 85.03  
FEET ALONG SAID EXTENSION AND SAID SOUTHWEST LINE TO THE  
NORTHWEST LINE OF SAID VACATED ROAD AND THE POINT OF  
BEGINNING; THENCE CONTINUING S37°20'04"E, 50.00 FEET ALONG  
SAID SOUTHWEST LINE TO THE NORTHWEST LINE OF LOT 1 OF  
CERTIFIED SURVEY MAP NO. 5738; THENCE S52°54'07"W, 145.01  
FEET ALONG SAID NORTHWEST LINE TO THE BEGINNING POINT OF A  
MEANDER LINE OF THE NORTHEASTERLY BANK OF A DREDGED CANAL,  
SAID POINT BEARS N52°54'07"E A DISTANCE OF 27 FEET MORE OR  
LESS FROM SAID NORTHEASTERLY BANK; THENCE N30°38'01"W,  
50.32 FEET TO THE TERMINATION POINT OF SAID MEANDER LINE  
AND THE NORTHWEST LINE OF SAID VACATED ROAD, SAID POINT  
BEARS N52°54'07"E A DISTANCE OF 26 FEET MORE OR LESS FROM  
SAID NORTHEASTERLY BANK; THENCE N52°54'07"E, 139.14 FEET  
ALONG SAID NORTHWEST LINE TO THE POINT OF BEGINNING.  
INCLUDING ALL THAT LAND LYING BETWEEN ABOVE DESCRIBED  
MEANDER LINE AND SAID NORTHEASTERLY BANK BOUNDED BY THE  
SOUTHWESTERLY EXTENSIONS OF THE NORTHWEST AND SOUTHEAST  
LINES SO DESCRIBED. SUBJECT TO ALL EASEMENTS AND  
RESTRICTIONS OF RECORD.

WATER NOTES:  
- WETLANDS, FLOODPLAIN, ETC. THAT MAY AFFECT THE SUBJECT  
PROPERTY HAVE NOT BEEN SHOWN PER CLIENT'S INSTRUCTIONS  
- THE ORDINARY HIGH WATER MARK IS NOT BASED ON AN  
OFFICIAL DETERMINATION AND PRIOR TO ANY BUILDING, AN OFFICIAL  
DETERMINATION OF THE ORDINARY HIGH WATER MUST BE MADE BY THE  
WINNEBAGO COUNTY ZONING DEPARTMENT OR OTHER AUTHORIZED PERSON  
- ANY LAND BELOW THE ORDINARY HIGH WATER MARK OF A LAKE OR A  
NAVIGABLE STREAM IS SUBJECT TO THE PUBLIC TRUST IN NAVIGABLE  
WATERS THAT IS ESTABLISHED UNDER ARTICLE IX, SECTION 1 OF THE  
STATE CONSTITUTION  
- THE LOCATION OF THE APPROXIMATE ORDINARY HIGH WATER MARK SHALL  
BE THE POINT ON THE BANK OF A NAVIGABLE STREAM OR ON THE SHORE  
OF A LAKE UP TO WHICH THE PRESENCE AND ACTION OF SURFACE WATER IS  
SO CONTINUOUS AS TO LEAVE A DISTINCTIVE MARK BY EROSION,  
DESTRUCTION OF TERRESTRIAL VEGETATION, OR OTHER EASILY  
RECOGNIZED CHARACTERISTICS.

NORTH IS REFERENCED TO THE EAST LINE OF  
THE NORTHEAST 1/4 OF SECTION 26, T20N,  
R14E, TOWN OF WOLF RIVER, WINNEBAGO  
COUNTY, WISCONSIN, WHICH BEARS  
N00°52'24"W PER THE WISCONSIN COUNTY  
COORDINATE SYSTEM (WINNEBAGO COUNTY)

I HEREBY CERTIFY THAT THE ABOVE DESCRIBED PROPERTY  
WAS SURVEYED AND MAPPED IN ACCORDANCE WITH AE-7 OF  
THE WISCONSIN ADMINISTRATIVE CODE AND IS CORRECT TO  
THE BEST OF MY KNOWLEDGE AND BELIEF.

*Christopher E. Perreault*  
CHRISTOPHER E. PERREAULT, PLS-2249 DATED 9/3/2025

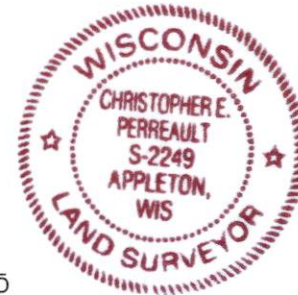

SCALE: 1" = 30'

CAROW LAND SURVEYING & ENVIRONMENTAL

615 NORTH LYNNDAL DRIVE

APPLETON, WI 54914

DATE: 9/3/2025

SCALE: 1" = 30'

DRAWN BY: FNZ

A2506.19