

8110463

# Plat of Survey

Lot 63, Eaglecrest Estates, City of Neenah,  
Winnebago County, Wisconsin



S00°38'36"E 91.62'

## LEGEND

- = Set 3/4" x 18" iron rebar  
Wt. = 1.502 lbs/lf
- ⊙ = Found iron pipe, 1" i.d.

LOT 63

12368 s.f.

LOT 64

N89°25'07"E 135.00'

SCALE: 1"=20'

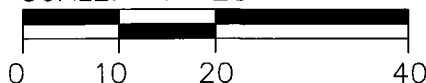

North is referenced to the east  
right-of-way line of Remington Road  
and is recorded to bear N00°38'36"W

N00°38'36"W 91.62'

Remington Road (60')

LOT 62

S89°25'07"W 135.00'

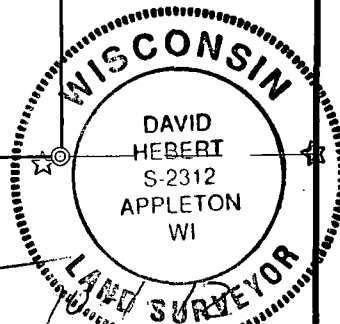

I, David Hebert, RLS, do hereby certify that this plat of  
survey is a correct representation of the lands described.



**Hebert Associates, Inc.**

LAND SURVEYING • SOIL TESTING

1110 W. Wisconsin Ave. 920-734-8373  
Appleton, WI 54914 Fax: 920-734-3968

FOR:

**Paul Verhagen**  
919 Shamrock Court  
Kaukauna, WI 54130

DATE: 10-1-12

DRAFTED BY: dh

SCALE: 1"=20'

DRAWING NUMBER:

12033A05