

PLAT OF SURVEY

DATED THIS 22ND DAY OF SEPTEMBER 2017

Lawrence C. Kriescher
WISCONSIN REGISTERED LAND SURVEYOR S-1599
LAWRENCE C. KRIESCHER

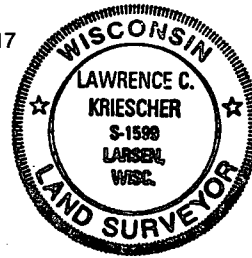

Curve 1-2
A=209.00'
R=1454.33'
D=08°14'02"
B=N 75°49'57" E
C=208.82'
T=104.68'
Dc=03°56'23"

Curve 3-4
A=188.58'
R=1421.33'
D=07°36'07"
B=N 76°08'54" E
C=188.44'
T=94.43'
Dc=04°01'52"

Curve 5-6
A=188.61'
R=2825.47'
D=03°49'29"
B=N 81°51'42" E
C=188.57'
T=94.34'
Dc=02°01'40"

Curve 6-7
A=182.74'
R=2792.47'
D=03°44'58"
B=N 81°49'26" E
C=182.70'
T=91.40'
Dc=02°03'06"

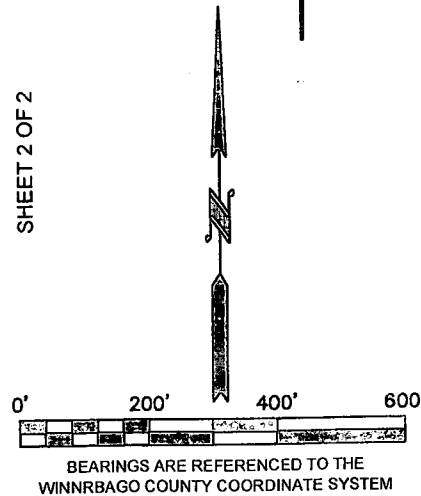

SHEET 2 OF 2

PARCEL 8 PID 020-0095

DESCRIPTION

A PART OF GOVERNMENT LOT TWO (2) LOCATED IN FRACTIONAL SECTION SIXTEEN (16), TOWNSHIP NINETEEN (19) NORTH, RANGE FOURTEEN (14) EAST, TOWN OF POYGAN, WINNEBAGO COUNTY, WISCONSIN CONTAINING 1432109 SQUARE FEET (32.877 ACRES) OF LAND AND BEING DESCRIBED AS FOLLOWS:

COMMENCING AT THE CENTER CORNER OF SAID FRACTIONAL SECTION 16 AND THE POINT OF BEGINNING; THENCE N89°02'33"W. 1319.47 FEET ALONG THE SOUTHLINE OF THE SW.1/4 OF SAID SECTION 16; THENCE N.00°07'12"E. 1087.04 FEET TO A POINT ON THE ORIGINAL CENTERLINE OF A TOWN ROAD (C.T.H B); THENCE N.79°56'57"E. 445.65 FEET ALONG SAID CENTERLINE; THENCE S.10°03'02"E. 130.50 FEET; THENCE N.79°56'58"E. 264.88 FEET; THENCE N.10°03'02"W. 130.50 FEET TO A POINT ON THE ORIGINAL CENTERLINE OF SAID TOWN ROAD (C.T.H. B); THENCE N.79°56'57"E. 137.08 FEET ALONG SAID LINE; THENCE S.45°28'32"E. 678.79 FEET; THENCE S.00°06'46"W. 781.04 FEET TO THE POINT OF BEGINNING AND BEING SUBJECT TO ALL EASEMENTS AND RESTRICTIONS OF RECORD.

PARCEL 9 PID NO. 020-0096

DESCRIPTION

A PART OF GOVERNMENT LOT TWO (2) LOCATED IN FRACTIONAL SECTION SIXTEEN (16), TOWNSHIP NINETEEN (19) NORTH, RANGE FOURTEEN (14) EAST, TOWN OF POYGAN, WINNEBAGO COUNTY, WISCONSIN CONTAINING 131808 SQUARE FEET (3.026 ACRES) OF LAND AND BEING DESCRIBED AS FOLLOWS:

COMMENCING AT THE CENTER CORNER OF SAID FRACTIONAL SECTION 16; THENCE N.00°06'46"W. 781.04 FEET TO THE POINT OF BEGINNING; THENCE N.45°28'32"W. 668.67 FEET TO A POINT ON THE CENTERLINE OF C.T.H. "B"; THENCE N.79°56'58"E. 295.67 FEET ALONG SAID LINE; THENCE NORTHEASTERLY 188.61 FEET ALONG THE ARC OF A CURVE TO THE RIGHT HAVING A RADIUS OF 2825.47 FEET AND A CHORD WHICH BEARS N.81°51'42"E. 188.57 FEET AND BEING THE CENTERLINE OF C.T.H. "B"; THENCE S.00°06'46"W. 547.18 FEET TO THE POINT OF BEGINNING AND BEING SUBJECT TO ALL EASEMENTS AND RESTRICTIONS OF RECORD.

LOT 2
CSM NO. 452

LOT 1
CSM NO. 7131

LANDS DESCRIBED IN
DOCUMENT NO. 1656190
AS PARCEL NO. 9
PID 020-0096

LANDS DESCRIBED IN
DOCUMENT NO. 1656190
AS PARCEL NO. 8
PID. 020-0095

CENTER OF SECTION
SECTION 16, T.19N., R.14E

L.C. KRIESCHER & ASSOCIATES LLC.

5251 GRANDVIEW ROAD

LARSEN, WI 54947

920-836-3576

DWG. NO. L-487