

PLAT OF SURVEY

LOT 24, BLOCK 2 OF WAMPATUCK RESORT, EXCEPTING THE SOUTHEASTERLY 4 FEET THEREOF, LOT 24, BLOCK 2 OF WAMPATUCK RESORT, EXCEPTING THE NORTHWESTERLY 4 FEET THEREOF, AND PART OF THE FRACTIONAL NORTHEAST 1/4 OF SECTION 9, ALL BEING PART OF SECTION 9, TOWNSHIP 18 NORTH, RANGE 16 EAST, TOWN OF OSHKOSH, WINNEBAGO COUNTY, WISCONSIN.

SURVEYOR'S CERTIFICATE

I hereby certify that I have surveyed the property as shown, according to official records and that the plat above drawn is an accurate and correct representation of said survey.

James E. Smith 4.18.17
Wisconsin Professional Land Surveyor Date



SURVEY FOR:
ROB VACHERESSE
2807 SUNSET POINT LANE
OSHKOSH, WI 54904

ALUMINUM MONUMENT ON THE EAST LINE OF GOVERNMENT LOT 4 IN SECTION 4, T18N-R16E

NORTHEAST CORNER SECTION 9, T18N-R16E COMPUTED LOCATION

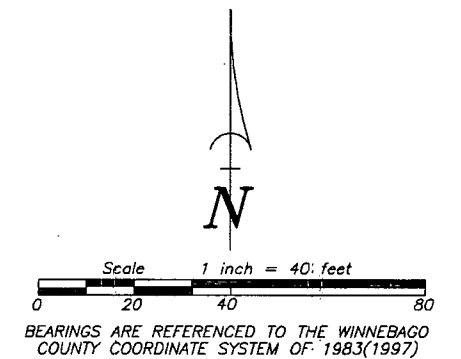

LEGEND

- 1-1/4" O.D. IRON PIPE SET, 18" LONG, WEIGHING 1.130 LBS. PER LIN. FOOT
- ▲ "MAG" NAIL SET
- 3/4" REBAR FOUND
- 1-1/4" O.D. IRON PIPE FOUND
- ⊗ CHISELED "X" SET ON RETAINING WALL
- ⊙ GOVERNMENT CORNER FOUND
- () RECORDED AS

Martenson & Eisele, Inc.



109 West Main Street
Omro, WI 54963
www.martenson-eisele.com
P 920.685.6240 F 920.685.6340
Planning
Environmental
Surveying
Engineering
Architecture

PROJECT NO. 0-2122-001

FILE 2122001POS.DWG

THIS INSTRUMENT WAS DRAFTED BY: DSL

