

PLAT OF SURVEY

ALL OF LOT 7 AND THE EASTERLY 16.66' OF LOT 8 IN "OKRUEG PLAT", LOCATED IN SECTION 7,
TOWNSHIP 18 NORTH, RANGE 16 EAST, TOWN OF ALGOMA, WINNEBAGO COUNTY, WISCONSIN.

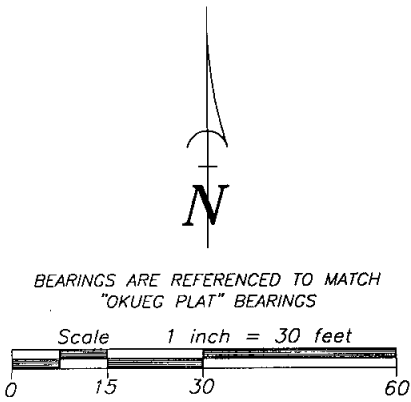

SURVEY FOR:
TIM SHEFCHIK
PORTSIDE BUILDERS, INC.
980 AMERICAN DRIVE
NEENAH, WI 54956

SITE ADDRESS: /
3860 HIGHLAND SHORE, LANE

TAX PARCEL NUMBER:
0021073 /

SURVEYOR'S CERTIFICATE

I hereby certify that I have surveyed the property as shown, according to official records and that the plat above drawn is an accurate and correct representation of said survey.

said survey.

James E. Smith 1/15/07

Wisconsin Registered Land Surveyor Date

Wisconsin Registered Land Surveyor

Date _____

LEGEND

- 1-1/4" O.D. IRON PIPE SET, 18" LONG,
WEIGHING 1.130 LBS. PER LIN. FOOT
□ 1-1/4" O.D. IRON PIPE FOUND
△ STONE MONUMENT FOUND
() RECORDED AS
-X-X- FENCE LINE

Martenson & Eisele, Inc.

Planning - Surveying - Engineering - Architecture

109 W. Main St., Omro, WI 54963
Phone (920) 685-6240 Fax (920) 685-6340

www.martenson-eisele.com
Email meomro@charter.net

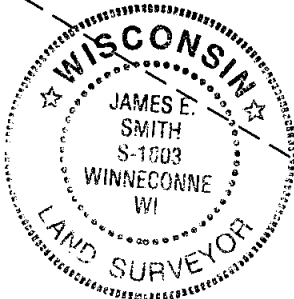

PROJECT NO. 0-1289-001

FIELD BOOK PAGE

FILE 1289001POS.DWG

THIS INSTRUMENT WAS DRAFTED BY: DSL