

# PLAT OF SURVEY

THE EAST 50 FEET OF LOT 12 AND THE WEST 30 FEET OF LOT 13, IN  
LANSING'S PLAT OF HIGH POINT, BEING PART OF GOVERNMENT LOT 1,  
SECTION 1, TOWNSHIP 18 NORTH, RANGE 15 EAST, TOWN OF OMRO,  
WINNEBAGO COUNTY, WISCONSIN.

SITE ADDRESS:  
4942 LANSING HIGH POINT ROAD

TAX PARCEL NUMBER:  
0160845

TOTAL AREA:  
13,568 SQ.FT.±/0.312 AC.±

30% = 4,070 SQ.FT.

|                           |               |
|---------------------------|---------------|
| EXISTING IMPERVIOUS AREA  |               |
| COTTAGE WITH OVERHANG     | = 943 SQ.FT.  |
| SHED WITH OVERHANG        | = 390 SQ.FT.  |
| BOAT HOUSE WITH OVERHANG  | = 294 SQ.FT.  |
| DECK ON COTTAGE           | = 418 SQ.FT.  |
| STEPS ON COTTAGE          | = 50 SQ.FT.   |
| DECK ON BOAT HOUSE        | = 161 SQ.FT.  |
| CONCRETE ALONG BOAT HOUSE | = 25 SQ.FT.   |
| GRAVEL                    | = 1684 SQ.FT. |
| WALKWAY TO SHED           | = 73 SQ.FT.   |
| STEPPING STONES           | = 40 SQ.FT.   |

TOTAL IMPERVIOUS AREA = 4,078 SQ.FT.  
= 30.06% IMPERVIOUS

## SURVEYOR'S CERTIFICATE

I hereby certify that I have surveyed the property as  
shown, according to official records and that the plat  
above drawn is an accurate and correct representation of  
said survey.

*Darryl S. Lehman* 2-11-25  
Wisconsin Registered Land Surveyor Date



PROJECT NO. 0-2967-001

FILE 2967001POS.DWG

THIS INSTRUMENT WAS DRAFTED BY: DSL

**Martenson & Eisele, Inc.**



101 West Main Street  
Omro, WI 54963  
www.martenson-eisele.com  
P 920.685.6240 F 920.685.6340

Planning  
Environmental  
Surveying  
Engineering  
Architecture

SURVEY FOR:  
CRAIG JONES  
1445 CANDLELIGHT COURT  
OSHKOSH, WI 54904

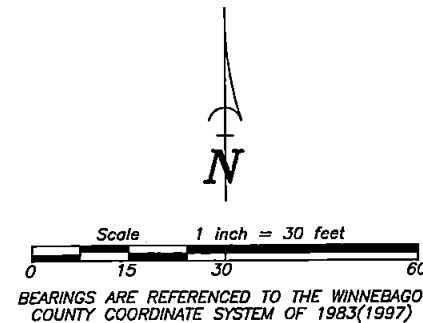

## LEGEND

- 1-1/4" O.D. IRON PIPE SET, 18" LONG, WEIGHING 1.130 LBS. PER LIN. FOOT
- 3/4" REBAR FOUND
- 1-1/4" O.D. IRON PIPE FOUND
- ▲ "MAG" NAIL SET
- 1-1/2" O.D. IRON PIPE FOUND
- ( ) RECORDED AS

