

Plat of Survey

Part of the Southwest 1/4 of the Southwest 1/4 of Section 34,
T17N-R16E, Town of Nekimi, Winnebago County, Wisconsin

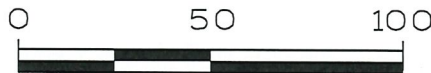

SCALE: 1" = 50'



Bearings referenced to
the South line of the
Southwest 1/4 of
Section 34, T17N-R16E,
assumed to bear
S88°41'48"E

NOTE:

This survey was performed by the Wisconsin Department of
Transportation and is intended to be used for describing excess
lands to be sold to the public. Please review county records to
determine current ownership.

Part of Parcel 2, Project ID 3887

Legend

- 1.32" (o.d.) x 18" iron pipe with cap
weighing 1.68 lbs/lin ft set
- 1" iron pipe found
- ⊙ 3/4" rebar found
- ⊕ Winnebago County monument - type noted
- fence line

Parcel A

Part of the Southwest 1/4 of the Southwest 1/4 of Section 34,
T17N-R16E, Town of Nekimi, Winnebago County, Wisconsin, more
fully described as follows:

Commencing at the Southwest Corner of Section 34, T17N-R16E;
thence S88°41'48"E, 360.00 feet along the South line of the
Southwest 1/4 of said Section 34; thence N27°10'07"W, 37.54 feet
to the North right of way of Lone Elm Ave, also being a South line of
Lot 1, Volume 1, Certified Survey Maps, Page 7056, Map No. 7056,
Document No. 1706415, Winnebago County records and the point
of beginning; thence N88°41'48"W, 153.20 feet; thence N0°54'44"E,
286.10 feet to the East right of way of Interstate Highway 41;
thence S27°10'07"E, 325.45 feet along said East right of way to the
point of beginning.

Parcel contains 21,914 square feet / 0.50 acres more or less.
Parcel subject to easements and restrictions of record.

Lot 1
CSM #7056

Surveyor's Certificate

I, Michael R. Andraschko, Professional Land Surveyor,
PLS-2895, do hereby certify that the above described
property was surveyed and mapped in accordance with
AE-7 of the Wisconsin Administrative Code and is correct
to the best of my knowledge and belief.

Michael R. Andraschko
PLS-2895
November 17, 2024

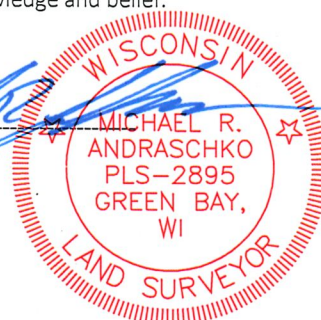

IH 41

width varies

